



Client

Evanston Park District

Prime Consultant/Reference

Thompson Dyke & Associates

Subconsultant

Delta Engineering Group, LLC

Start Date: Nov. 2007

Completion Date: Dec. 2008

Total Project Costs: \$250,000

**Evanston Lighthouse Landing
ADA Improvements**

Services Provided: Structural Engineering, Plumbing and Lighting

Delta Engineering Group was engineering consultant to Thompson Dyke & Associates and Urban Works Ltd. for ADA Improvements to Lighthouse Landing, Evanston Park District, located at 2603 Sheridan Road, Evanston, IL.

Lighthouse Landing is a 6.5-acre park located just north of the Evanston Arts Center (Historic Clarke Estate and Light House) along Lake Michigan in northern Evanston. The facility serves the entire community and includes a restroom facility and beach, and a new playground currently under construction. This project required design and construction of ADA access to the existing restroom facility and beach, including required improvements to the restroom facility and beach access to Lake Michigan water line. Design was based on a schematic developed by the Evanston Park District. This project is within the bounds of a local Historic Landmark and a federal historic district. Delta Engineering, Inc. provided structural design of the ADA ramp and necessary retaining wall(s) from the upper level parking lot down to a patio at restroom level and down to the beach and water line. Delta also provided site lighting improvements.

Delta services included design development, preparation of construction documents, assistance in bidding, and construction administration.

Existing Conditions ↓



Final ↑

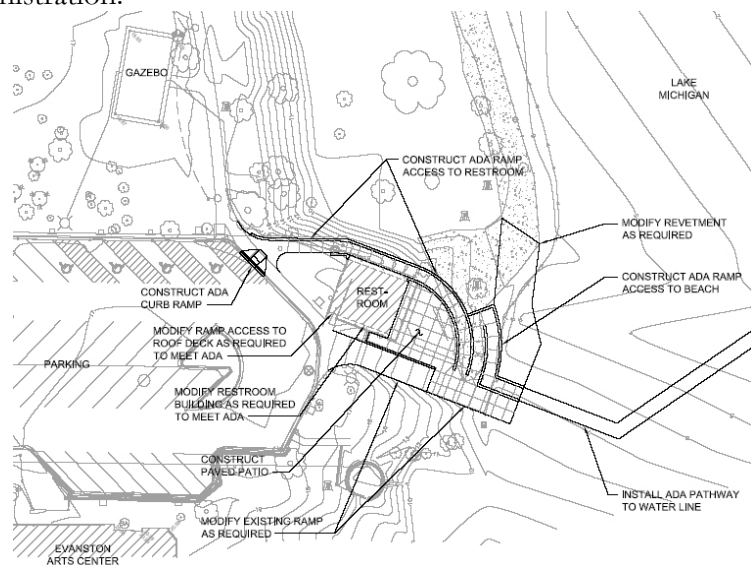

Delta Engineering Group, LLC
111 W. Jackson Blvd.
Chicago, IL 60604
312-377-7700

www.deg-america.com